

943.11 SCHEDULE OF CHARGES AND FEES

(To review all Cemetery Rules and Regulations, please see www.medinah.org/city-hall/cemetery)

| LOT FEES PER GRAVE: | | | |
|---|---------------------------|--|---|
| Lot Type | No. of Lots | Resident | Non-Resident |
| A | per grave | \$550.00 | \$650.00 |
| B | per grave | \$750.00 | \$850.00 |
| C | per grave | \$650.00 | \$750.00 |
| Remains Section | per grave | \$200.00 | \$250.00 |
| Baby Section | per grave | \$200.00 | \$250.00 |
| DESCRIPTION OF SALEABLE LOTS: | | | |
| Class "A" lots, single or multiple graves: All Sections except 14, 17, 18 and 19 | | | |
| Class "B" lots, single graves: Section 14 and 17 | | | |
| Class "C" lots, single graves: Section 18 and 19 | | | |
| Remains Section: Section specifically located in Section 8 | | | |
| Baby Section: Single grave only, available in sequential order | | | |
| INTERMENT FEES: | | | |
| Interment of Residents or Non-residents | Before 2:00 p.m. Weekdays | After 2:00 p.m. Weekdays and until 12:00 Noon Saturday | After 12:00 Noon Saturday or Sunday (Court Ordered) and approved holidays |
| Adult | \$500.00 | \$650.00 | \$750.00 |
| Remains Section | \$250.00 | \$350.00 | \$500.00 |
| Baby Section | \$250.00 | \$350.00 | \$500.00 |
| Crypt Sealing | \$150.00 | \$250.00 | \$400.00 |
| DISINTERMENT AND REINTERMENT FEES: | | | |
| | Adult Vault | Adult Remains | Infant |
| Disinterment | \$1,050.00 | \$300.00 | \$400.00 |
| FOUNDATION FEES: | | | |
| A fee of \$0.50 shall be charged per square inch of surface material of concrete. All footers shall have a two inch (2") border around the entire base. Flush markers shall not have a mandatory border. | | | |
| COLUMBARIUM/NICHE WALL: (remains interments only) | | | |
| CLBM - 1 One (1) Niche - \$950.00 | | | |
| CLBM-2 One (1) Niche - Top Row - \$1,350.00 | | | |
| CLMB-2 One (1) Niche - Middle Row - \$1,250.00 | | | |
| CLMB-2 One (1) Niche - Bottom Row - \$1,150.00 | | | |
| Interment - \$250.00 per opening (max. two (2) per Niche) | | | |
| Engraving - Actual cost | | | |
| ADDITIONAL SERVICES: | | | |
| <ol style="list-style-type: none"> 1. Upon request, the Director of Public Service shall give written estimates of work to be done by cemetery employees on the cemetery grounds not covered in the foregoing schedules. 2. There shall be a \$50.00 charge for chapel use for a funeral or memorial service. 3. Endowment Fee. There shall be a one (1) time Special Lot Endowment Fee of \$1,000.00 to provide for special care of a grave or lot on Memorial Day and Christmas. 4. There shall be a \$30.00 Transfer of Lot Fee for all lot transfers. (Ord. 184-17. Passed 12-11-17; Ord. 58-18. Passed 3-26-18.) | | | |

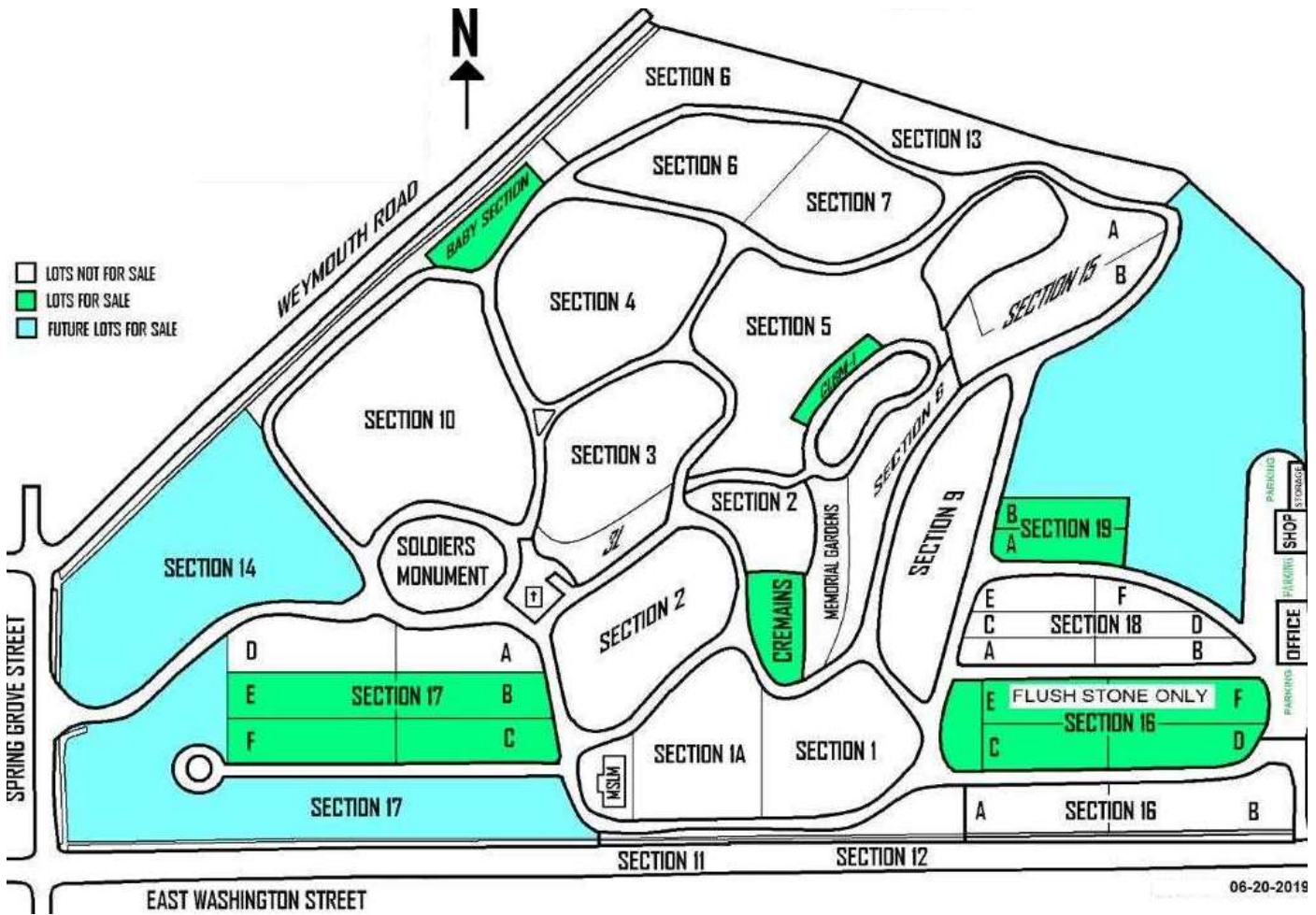

MONUMENT COMPANIES

These are the companies that are normally used however the City does not endorse / nor limit any specific company.

NOTE: Please consult Rules and Regulations Section 943.06 (1) Ordinance No. 45-20 for monument specifications..

Contact Spring Grove Cemetery for a Footer Application.

MONUMENT WORKS
Address: 155 KOONS AVE.,
 MEDINA, OH 44256
Phone: (330) 725-2831
 FAX: N/A

KOTECKI FAMILY MEMORIALS
Address: 127 W Smith Rd,
 Medina, OH 44256
Phone: (330) 725-8848
 FAX: (330) 722-5862

THOMPSON-CHAPMAN MEMORIALS
Address: 327 S Market St,
 Wooster, OH 44691
Phone: (330) 264-8703
 FAX: (330) 601-1016

MIDWEST EVERLASTING MEMORIALS
ADDRESS: 1244 HIGH STREET,
 WADSWORTH , OH 44281
PHONE: (330) 334-1988
FAX: (330) 334-1989
WWW.MIDWESTEVERLASTINGMEMORIALS.COM

MILANO MONUMENTS
Address: 14600 Brookpark Rd,
 Cleveland, OH 44135
Phone:(216) 362-1199
 FAX: (216) 362-8230

PERTEE MONUMENTS
Address: 4105 Cleveland Rd,
 Wooster, OH 44691
Phone: (330) 345-8811
 FAX: (330) 345-3404

JOHN CARABELLI
ADDRESS: 14110 Brook Park Rd.
 Brook Park, OH 44121
PHONE: 216-267-8585

Seasonal Clean Off: The Annual spring clean off is **March 16, 17 and 18**. The Annual fall clean off will be **October 19, 20 and 21**.

Footer Pours: For upright monuments, footers are poured three times annually. Typically July / August; August / September and September / October. *All subject to change, based on weather.*